

Product

AR-321-CM



USB to RS-485

(Non-isolation USB/485 Converter)

Notice:

Before connect to your computer, please must install USB driver from SOYAL website

For detailed installation instructions, please refer to:

[Comparison Chart of Driver Versions of AR-321CM Chip and Operation System](#)

Specification

Product	AR-321-CM
Converting Interface	USB/RS-485
Voltage	5 VDC
Baud Rate	4800 bps~115200 bps
Power Consumption	< 1W
Operation Temperature	-20℃ to +70℃
Active Distance	300M [RS-485]
Optical Isolation	2.5KV
Surge Protection	3KV
Electrical Isolation	2500V RMS
Dimension(cm)	76(H)x37(W)x16.4(D)
N.W.(g)	60±5

PIN Define

RS-485 Interface

PIN	06	05
Description	B (-)	A (+)

USB Interface

PIN	1(Red)	2(White)	3(Green)	4(Black)
Description	VDC	D-	D+	GND

Indicators

1. Power LED will keep lighting up in green after USB plugged.
2. RX flashing means data is receiving from RS-485 to USB.
3. TX flashing means data is transmitting from USB to RS-485.

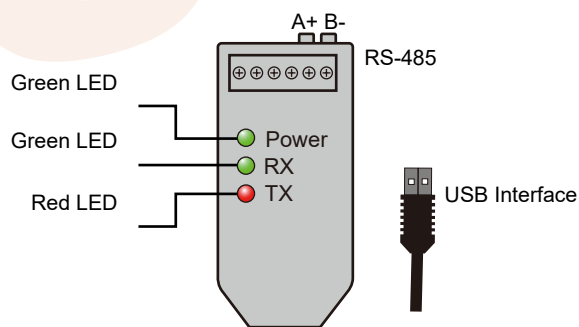

Installation

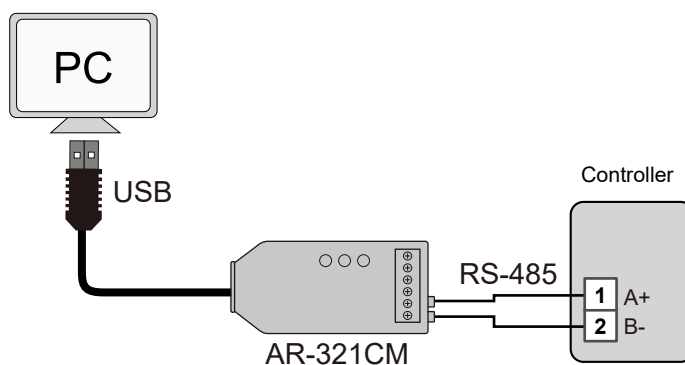

※ **Note:** To enable RxTx indicator lights, check the "Enable Event Polling" option in the [COM]  function of 701ServerSQL software.

For detailed installation instructions, please refer to:

[The Introduction of USB to RS-485 Converter AR-321-CM Signal and the Solution of Abnormal Connection.](#)

☒ Enable Event Polling

Troubleshooting

Q : How to resolve the issue of AR-321-CM default COM port jumping to a high number like COM21 in recent factory shipments?

STEP 1 :

Click on Device Manager, locate Prolific XXXX.

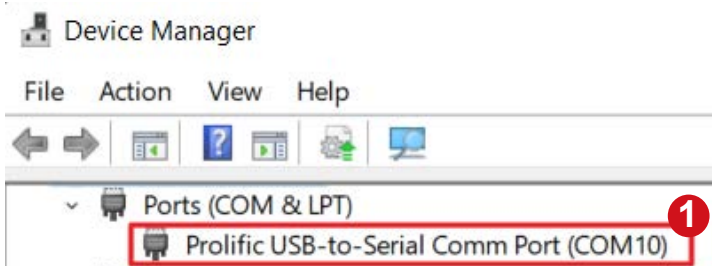

STEP 2:

Right-click on Prolific XXXX, choose [Properties]

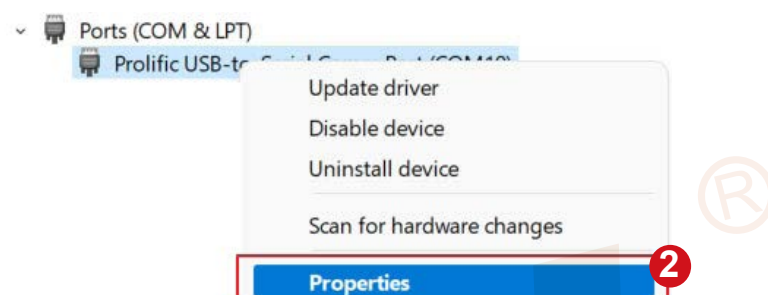

STEP 3: Choose an unused COM, in this example, COM13 is selected.

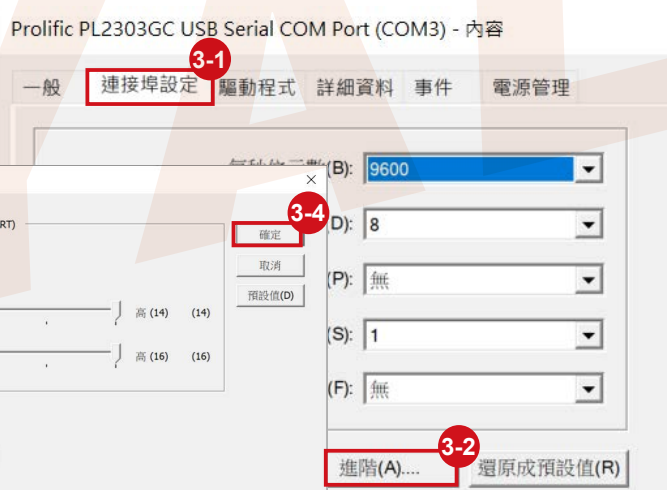

3-1 Click on [連接埠設定]

3-2 Click on [進階內容]

3-3 Choose an unused COM, in this example, COM13 is selected.

3-4 Press [確定]

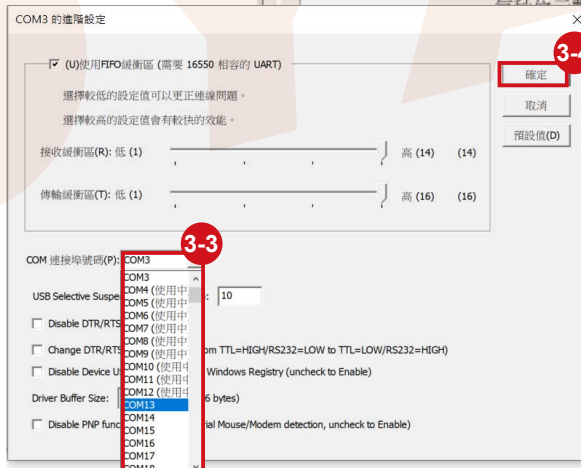

STEP 4:

After modification, 701Server can now select COM13.

