

# SOYAL<sup>®</sup>

## Industry Series

# AR-727-CM-IO-0804M

## Modbus Gateway Serial-to-Ethernet Server with I/O Module

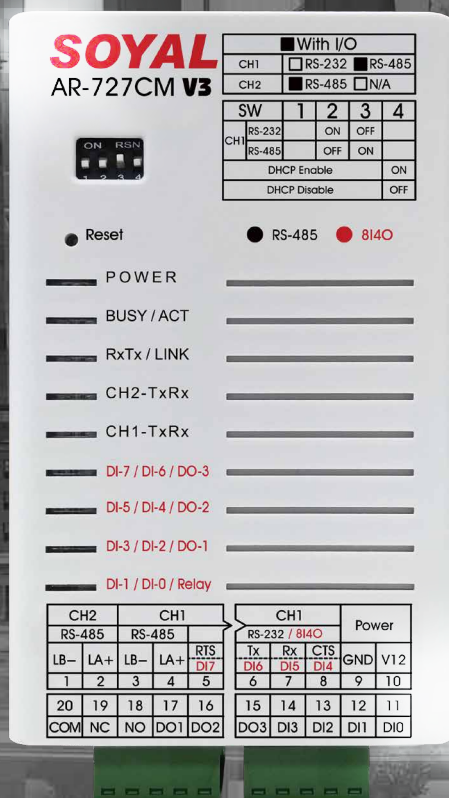

### Multi-Modbus Protocol Supported

TCP/IP to Wiegand  
TCP/IP to Serial  
To get status of on board I/O, Modbus TCP or Modbus RTU over TCP are supported  
Modbus TCP to Modbus RTU Auto Conversion (Applicable for Ethernet & WIFI)

### TCP Connection LED Indicator

ACT led indicating TCP connection status for visual check and trouble shooting.

### Surge Protection

Power: Bi-directional avalanche breakdown device  
RS485: Bi-directional avalanche breakdown device

### Simulation of Wiegand Output

DO-1 is able to simulate WG Data:1, and DO-2 is able to simulate WG Data:0, supporting WG output up to 128 bits

## Features



### Remote I/O Function

With I/O logic for conditional control, suitable for remote monitoring and control



### Two Channels Transmission & Receipt

Built-in two channels with buffer 1K for each transmission and receipt without missing data, suitable for transmission of massive data



### IoT Application

Wide applications in IoT monitoring, Factory Automation or remote monitoring equipment.

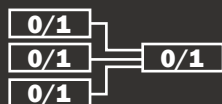

### SOYAL Protocol

Support SOYAL Protocol, integrated with SOYAL access control and SCADA. Support all-door release when fire alarm is triggered

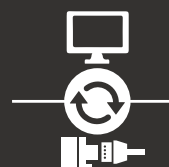

### Multi-data conversion

Supporting TCP/IP to WG, TCP/IP to Serial, TCP/IP to I/O.

## SPECIFICATION

Model No.		AR-727-CM-IO-0804M	
Hardware	Interface	Ethernet	10/100 Mbps Base T Ethernet <--> RS485
		Serial port (CH1/CH2)	RS485 *2 Baud Rate 2400 bps - 115200 bps (By order: RS232, RS232+RS485) Auto detect suppor TCP/Server 、TCP/Client 、UDP Mode
		Digital Inputs/Outputs or WG port	8 Digital Input / 4 Digital Outputs: 1 Relay Output + 3 DO or DO-1 is able to simulate WG Data:1, and DO-2 is able to simulate WG Data:0, supporting WG output up to 128 bits. Auto add even and odd parity bit and various format, etc.
	Protocol		ModBus-TCP, ARP, IP, TCP Client, UDP, ICMP, HTTP, DHCP, NetBIOS
	CPU		ARM 32bit
	Serial Buffer		1K each channel
	LED Indicator		Power: Tx/Rx, D.O./D.I
	Watchdog Function		Yes
	Surge Suppression		400W peak power dissipation. Clamping time < 1 picosecond (theoretical) Power: bi-directional avalanche breakdown device. RS485 bi-directional avalanche breakdown device.
	Fuses		Power & RS485 both with PTC Protector
	Isolation		optical 5 kV
	Power Supply		9-24 VDC
	Power Consumption		<2W
	Dimension (mm)		106.5(W)x66(H)x27.7(D)
	Weight (g)		approx. 120
Software	OS Supported		Windows 7 / 8 / 10, Win Server 2008/2012/2016
	Network / Device setting		701Server, 701Client, HTTP Web browser
Enviroment	Operating Temperature		-20°C ~ +70°C
	Storage Temperature		-40°C to +75°C
	Operating Humidity		0%~90% (non-condensing)
	Storage Humidity		0%~95% (non-condensing)

## INSTALLATION(mm)

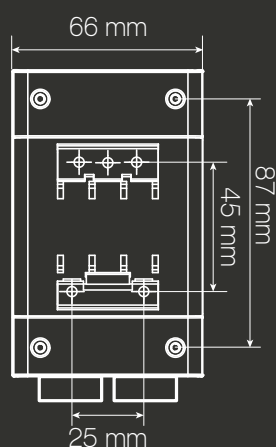

(Front View)

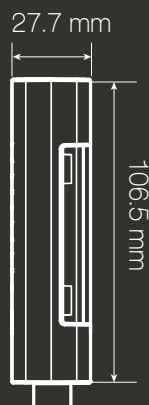

(Side view)

## HOW TO ORDER

**AR-727-CM-IO-0804M**

**Controller Option**

IO=I/O Module Series

**Input Qty / Output Qty**

0804=8 Input & 4 Output

**Output Type**

M=Mosfet

## APPLICATION & STRUCTURE DIAGRAM

### • Seamless integration with Face Recognition & Access Control System

The most flexible way to integrate any IP-Based devices, with AR-727-CM-IO-0804M Serial to Ethernet Networking Device (with Digital Input/Output), such as IP-CAM, IP-Face Recognition, IP-LPR (License Plate Recognition), I/O trigger electric lock, etc. No need other software.

Supporting TCP/IP to Wiegand output. Help easy integration among surveillance system and access control system as total solution with any brand.

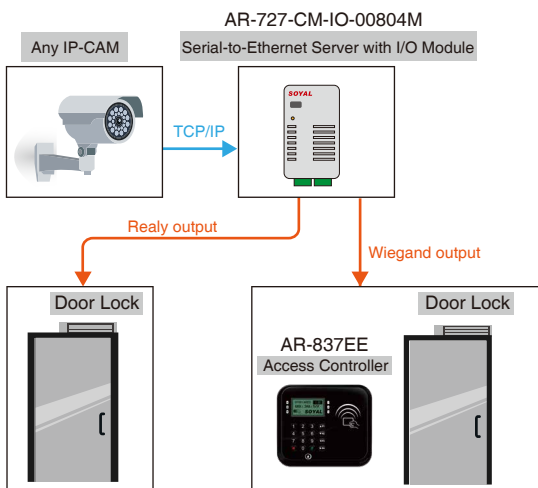

### • Fire-Alarm release all doors

Providing various of customized firmware to meet all customer needs, eg. release all doors or specified doors via RS485 or Ethernet once fire-alarm event

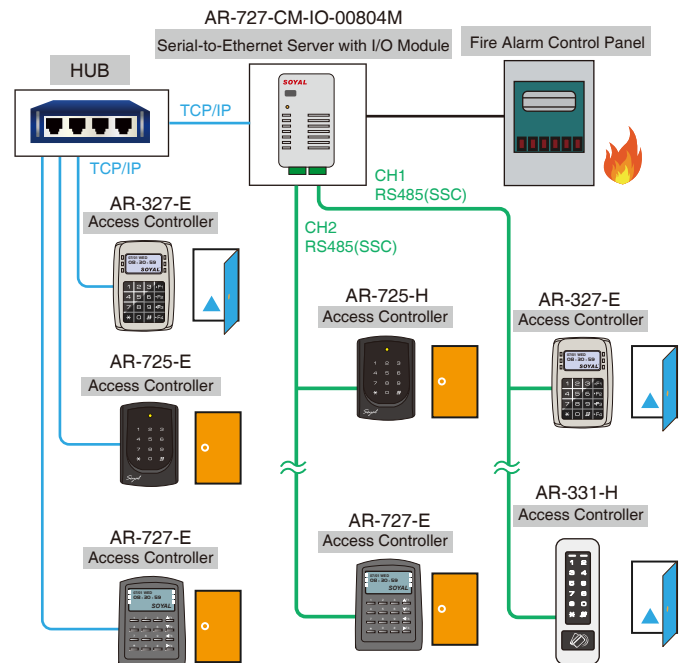

### • Remotely I/O linkage control application

AR-727-CM-IO-0804M can fulfill the linkage control in different locations such as trigger DI in location A; linkage DO in location B. Suited to remote control equipment or alarm warning linkage.

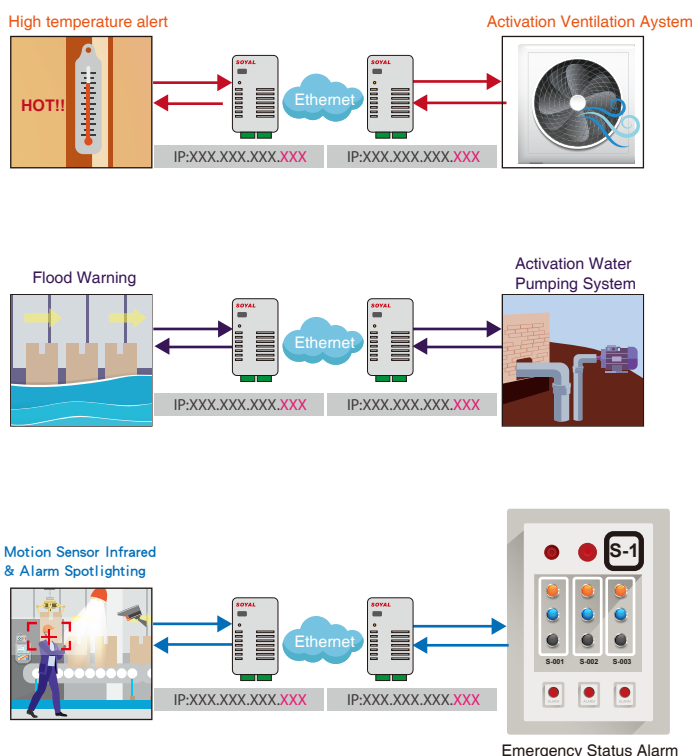

### • Mobile APP - I/O control lighting, electric lock & door contact status

SOYAL 727APP working with AR-727-CM-IO-0804M module that has built-in 8 digital inputs and 4 digital outputs, each I/O name can be self-defined, showing status of each DI; setting Normal Open/Normal Close of each DO with delay time (0.1~600 seconds) to fulfill smart life style through mobile APP.

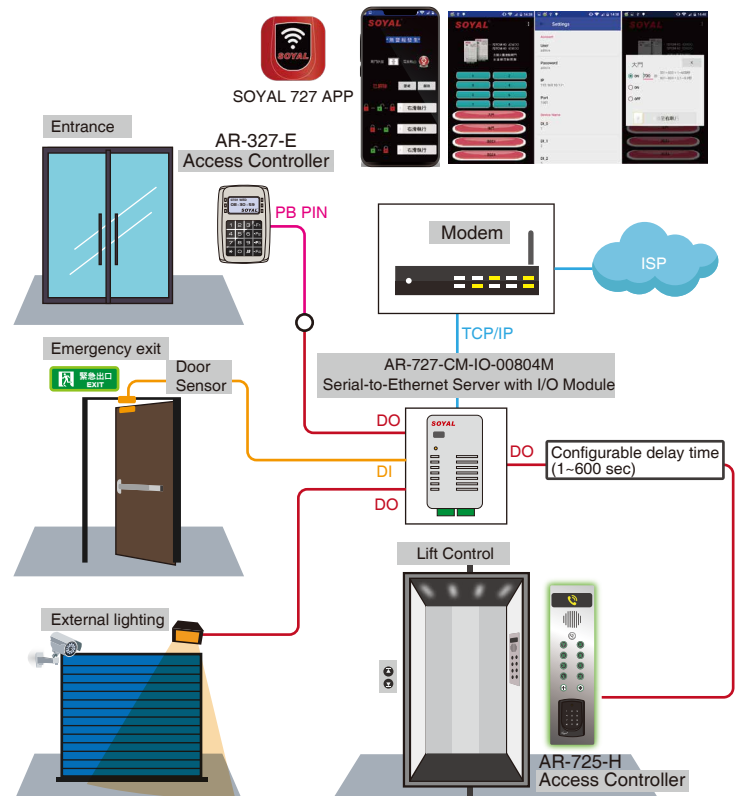

## SCADA Solutions



Remotely control I/O status

Support various devices on one Scada Mapping

Create multiple windows for each Scada Mapping

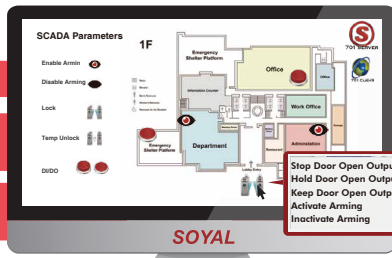

Set up abnormal events indicator for pop-up message

New icon status and mapping is available

Create your own icon and mapping

Ethernet

AR-727-CM-IO-0408M  
Serial-to-Ethernet Server with I/O Module

CH1 RS485 CH2 RS485 DI DO

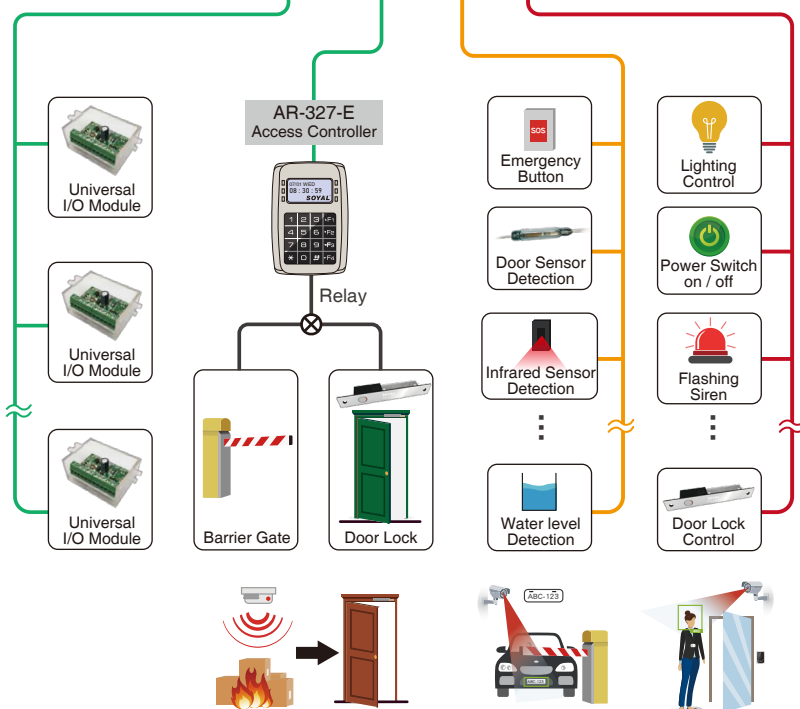

TCP/IP convert to RS-485  
(2 Channel) + Release all  
door locks in fire event

Remote I/O monitoring  
and control

\*SSC(SOYAL SECURITY COMMUNICATION)



SOYAL 727 APP

AR-727-CM-IO-0408M  
Serial-to-Ethernet Server with I/O Module

DI DO

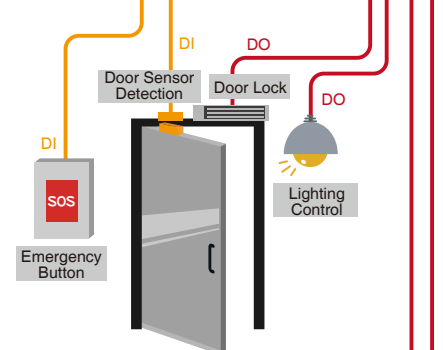

USB serial I/O control application

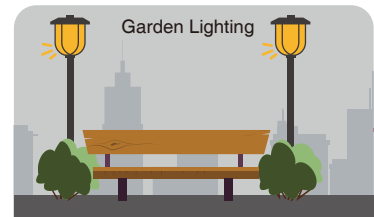
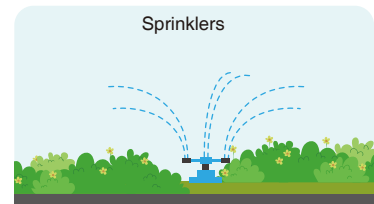

More FAQ